

Silicone Finger Test Probes

Test Method Reference: ASTM F1578 and F1597

OVERVIEW

These finger probes can be used as a repeatable probe for cycle testing switches, buttons and membrane switches and touch screens. The silicone finger probe design meets the specifications as set forth in the ASTM F1578 and ASTM 1597 (figure 1 or figure 2). The conductive option works great for capacitive touch screens.

Life cycle testing requires a repeatable method and device for consistent testing and these probes should be part of the device. These can be used on Norman Tool button and contact testers as well as adaptable for other brands of testers.

FEATURES

- Consistent Durometer
- Durable for Life Cycle Testing
- Available in various threaded mounting sizes
- Conductive Option is available

SPECIFICATIONS

- **Dimensions:** Within ASTM specifications F1578 & F1597
- **Durometer:** Shore A 45 +/- 5 (50 +/-5 for conductive probes)

ORDER INFORMATION

- **FP1-0832** #8-32 Male Thread (ASTM Fig1)
- **FP1C-0832** #8-32 Male Thread Conductive Black (ASTM Fig 1)
- **FP1-1032** #10-32 Male Thread (ASTM Fig1)
- **FP2-0540** #5-40 Female Thread (ASTM Fig 2)
- **FP2-0832** #8-32 Female Thread (ASTM Fig 2)
- **FP2-1032** #10-32 Female Thread (ASTM Fig 2)
- **FPA-M408** Thread adaptor M4x0.7 male x #8-32 female
- **FPA-M508** Thread adaptor M5x0.8 male x #8-32 female



Pledge for Quality

*Look for our new seal
for your Certified
Norman Tool equipment
purchases. Guaranteed
quality, made in the USA.*

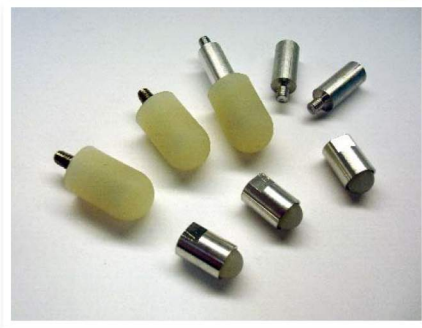

**All probes listed satisfy
ASTM F1578 & F1597
Figure 1 or 2 as listed**



NORMAN TOOL
TEST EQUIPMENT & SUPPLIES

A Global Leader Since 1964

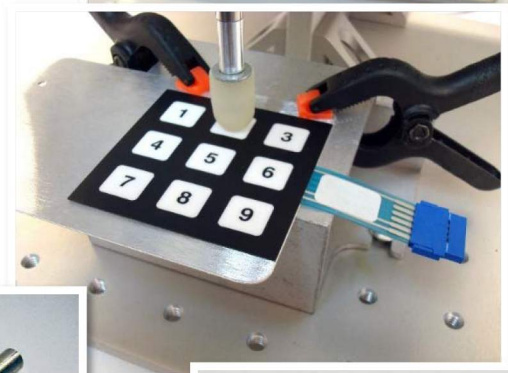

Finger Probe Dimensions

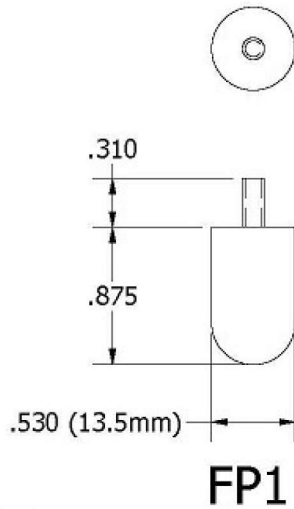

SILICONE
45+/-5 DUROMETER (SHORE A) WHITE
50+/-5 DUROMETER FOR CONDUCTIVE PROBES, BLACK
AS TESTED BY ASTM METHOD D2240

ASTM DIAMETER SPECIFICATION RANGE
.5 in (12.7 mm) to .875 in (22.2 mm)

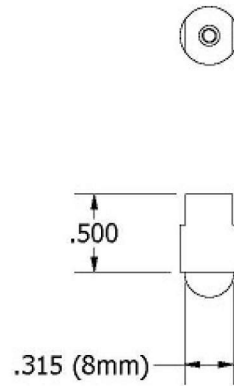

SILICONE
45+/-5 DUROMETER (SHORE A) WHITE
50+/-5 DUROMETER FOR CONDUCTIVE PROBES, BLACK
AS TESTED BY ASTM METHOD D2240

ASTM DIAMETER SPECIFICATION RANGE
.31 in (8 mm) to .39 in (10 mm)

Adaptor Dimensions

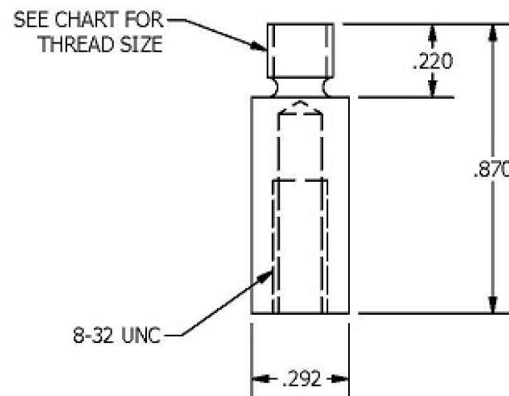

Finger Probe Mounting Adaptors		
Part #	Male Thread Size	Description
FPA-M408	M4 x 0.7	M4 male x #8-32 female (for 35N actuator)
FPA-M508	M5 x 0.8	M5 male x #8-32 female (for 9.2N actuator)